

Project : _____
 Type : _____
 Drawn by : _____
 Catalogue No. : _____
 Date : _____



Specifications

Model No.		<input type="checkbox"/> VO-SC2W30-120-P-3WAY/WH	<input type="checkbox"/> VO-SC2W30-120-P-3WAY/BK
General	Watts	2x15W	2x15W
	Lume	2800lm	2800lm
	CCT	3CCT(3000K/4000K/5000K)	3CCT(3000K/4000K/5000K)
	Volts	120V	120V
	CRI	>80	>80
	Beam Ange	100 degree	100 degree
	Sening Degree	180 degree	180 degree
	Sening Distance	52.49ft (16m)	52.49ft (16m)
	Hours Rated	35000 hours	35000 hours
	Sensor	Pyroelectric Infrared Sensor (PIR)	Pyroelectric Infrared Sensor (PIR)
Installation Method	Wire Connection	Wire Connection	
Electrical	Operating Frequency	60Hz	60Hz
	Power Factor	>0.7	>0.7
	Operating Position	Both-Horizontal&Vertical	Both-Horizontal&Vertical
	Operating mode	PIR Sensor	PIR Sensor
	Operating Temperature	-30C(-40F) TO 40C(104F)	-30C(-40F) TO 40C(104F)
Physical	MOL	11.88in	11.88in
	MOW	5.72in	5.72in
	MOH	5.92in	5.92in
	Lens Material	Frosted PC	Frosted PC
	Housing Color	White	Black
	Weight (Kg)	5.15	5.15
Additional Information	Additional Info	CCT adjustable	CCT adjustable
	"On" Duration time	15 min/5min/1min/Test(5s)	15 min/5min/1min/Test(5s)
	Warranty	3 years	3 years
Compliance	Safety Listing	ETL-Listed	ETL-Listed
	Location Rating	Wet Location/IP65	Wet Location/IP65
	Energy Star	No	No
	DLC Approved	No	No
	DLC ID	No	No

Features & Specifications

Construction	<ul style="list-style-type: none"> • PIR sensor with lux detection controls light on and off • PIR detection range can reach 52.49ft at 8.2ft height installation and PIR sensor set at 45° • The angle of two light head can be adjusted in both side, horizontal 45° and vertical 270° • PIR sensor can be adjusted in both side, vertical 135° and vertical 45°
Mounting	<ul style="list-style-type: none"> • Mounting location: wall or eave mounted • Mounting height 8.2ft is recommended above the ground
Performance Data	<ul style="list-style-type: none"> • Available in 3000K/4000K/5000K selectable color temperature • The light can be always be on when setting sensitivity position to ON • CRI80 • Estimated life of 35000hours • Operating temperature -30°C to 40°C
Compliances	<ul style="list-style-type: none"> • ETL certified for wet location • Outdoor use, IP65 waterproof • Complies with Part 15 of the FCC rules

Dimensions & Weights

Model	VO-SC2W30-120-P-3WAY
Length in. (cm)	11.88 (30.18)
Width in. (cm)	5.72 (14.53)
Height in. (cm)	5.29 (13.44)
Net weight (lbs)	11.35

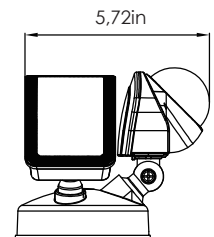
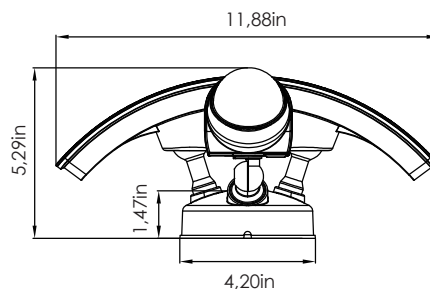

Product Details



PIR Sensor

Part Number	Technology	Height (Ft)	DetectionArea (M)	Time setting (Min)	Light control (Lux)	IP rating	Temperature (°C)
PIR Sensor	Pyroelectric infrared Sensor (PIR)	8.2ft is recommended	distance within 16M degree 180°	Test(5s), 1min, 5min, 15min	light on when lux under 50lux light off when lux over 150lux	IP65	-30°C~+40°C (-40°F~+104°F)

NOTE : PIR sensor with lux detection controls light on and off.

When sensitivity is set to ON(PIR detection is switched off), security light will be constant on and can control the light ON/OFF by switch.

PIR detection range can reach 52.49ft at 8.2ft height installation and sensor set at 45°

PIR sensor can be adjusted in both side,vertical 135°and vortical 45°

DEAFULT SETTING :

Brightness : 100%

Hold Time: 1min

Sensitivity: High

Day Light: OFF



Detection distance:

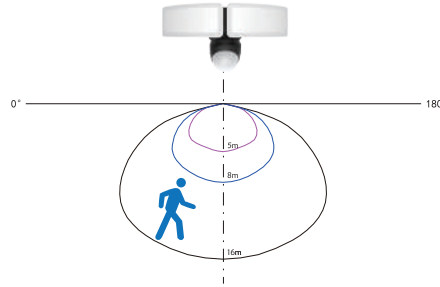

Installation recommended:

This product must be installed in accordance with applicable installation code by a person familiar with the construction and operation of the product and the hazards involved.

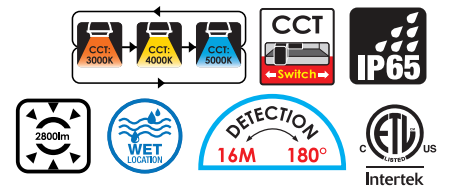
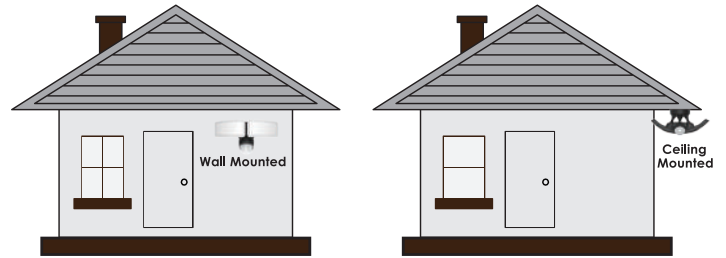

Data is based upon tests performed in a controlled environment. Actual performance can vary depending on operating conditions. All products are subject to change or may be discontinued any time without notice. Please contact your Votatec customer service representative to confirm inventory levels at time of order

